

Liquid Automatic Changeover Devices

Electrical Heating Type Vaporisers



LAX-20C

External Dimensions

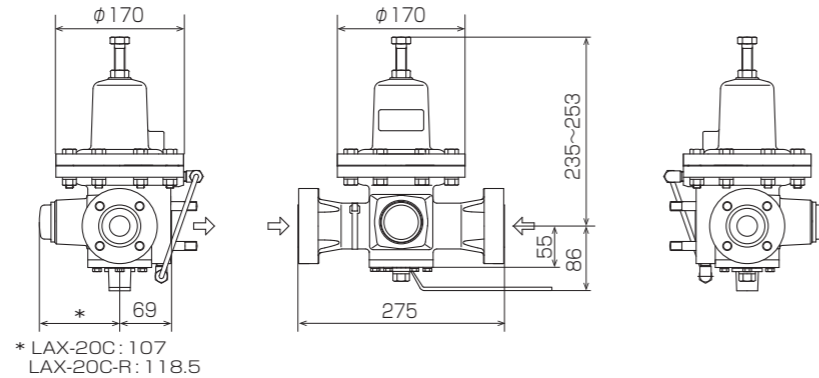

Accessories

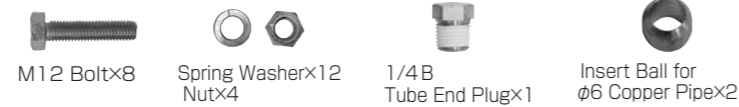

Specifications

Gas Type	LPG(Liquid LPG)												
Maximum Flow Rate	300kg/h												
Changeover Pressure	0.05~0.15MPa												
Changeover Operating Pressure Allowance	± 0.01 MPa												
Required Inlet Pressure (Minimum Pressure at Reserve Side)	(Changeover Pressure + ΔP) ~ 1.56MPa The values for ΔP are shown below;												
	<table border="1"> <tr> <td>Q; Flow Rate(kg/h)</td> <td>100</td> <td>150</td> <td>200</td> <td>250</td> <td>300</td> </tr> <tr> <td>ΔP(MPa)</td> <td>0.03</td> <td>0.07</td> <td>0.11</td> <td>0.14</td> <td>0.18</td> </tr> </table>	Q; Flow Rate(kg/h)	100	150	200	250	300	ΔP (MPa)	0.03	0.07	0.11	0.14	0.18
Q; Flow Rate(kg/h)	100	150	200	250	300								
ΔP (MPa)	0.03	0.07	0.11	0.14	0.18								
Connection	Equivalent to JIS20K20A Flange												



LAX-20C-R

With Signal Transmitting Function

External Dimensions

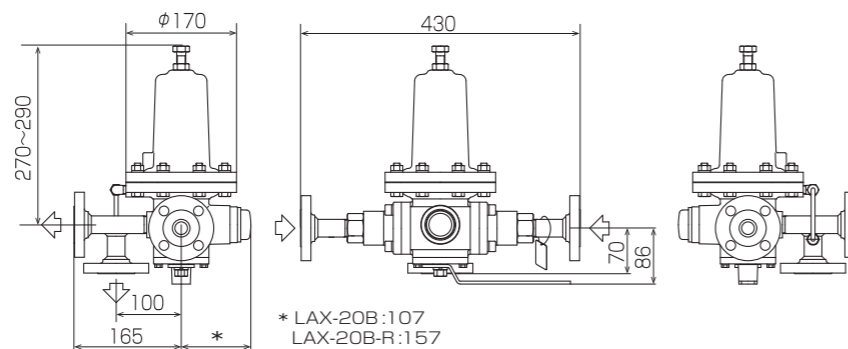

Accessories

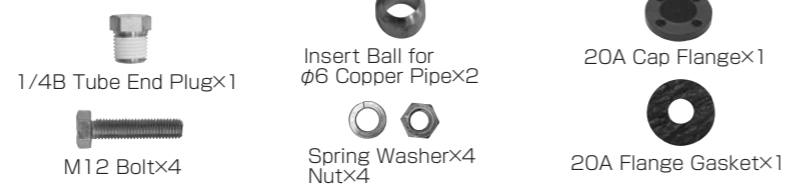

Specifications

Gas Type	LPG(Liquid LPG)												
Maximum Flow Rate	300kg/h												
Changeover Pressure	0.05~0.15MPa												
Changeover Operating Pressure Allowance	± 0.01 MPa												
Required Inlet Pressure (Minimum Pressure at Reserve Side)	(Changeover Pressure + ΔP) ~ 1.56MPa The values for ΔP are shown below;												
	<table border="1"> <tr> <td>Q; Flow Rate(kg/h)</td> <td>100</td> <td>150</td> <td>200</td> <td>250</td> <td>300</td> </tr> <tr> <td>ΔP(MPa)</td> <td>0.03</td> <td>0.07</td> <td>0.11</td> <td>0.14</td> <td>0.18</td> </tr> </table>	Q; Flow Rate(kg/h)	100	150	200	250	300	ΔP (MPa)	0.03	0.07	0.11	0.14	0.18
Q; Flow Rate(kg/h)	100	150	200	250	300								
ΔP (MPa)	0.03	0.07	0.11	0.14	0.18								
Connection	JIS20K20A Flange												



LAX-20B



LAX-20B-R

With Signal Transmitting Function



f RIZER Type S

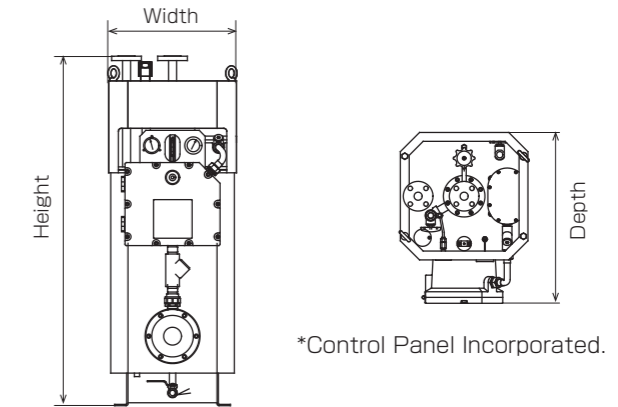

Specifications

Items	Model	S-50	S-100	S-150	S-200	S-300
Vaporisation Capacity (LPG)		50kg/h	100kg/h	150kg/h	200kg/h	300kg/h
Heat Source	Heater Capacity	7.5kW	15kW	22.5kW	30kW	45kW
	Rated Voltage	220/380/440V 3-Phase				
Hot Water Control Temperature		60~75°C (70°C Set Point)				
Hot Water Superheat Prevention		80°C				
Liquid Carryover Protection		By means of Float Valve				
Working Pressure for Safety Valve		1.80MPa				
Inlet Pressure		0.10~1.56MPa				
Connection	Liquid Inlet Flange	Equivalent to JIS 20K20A				
	Gas Outlet Flange	Equivalent to JIS 20K20A		Equivalent to JIS 20K25A		
External Dimensions	Width	420mm	420mm	480mm	580mm	580mm
	Depth	570mm	570mm	630mm	740mm	740mm
	Height	1115mm	1183mm	1253mm	1215mm	1315mm

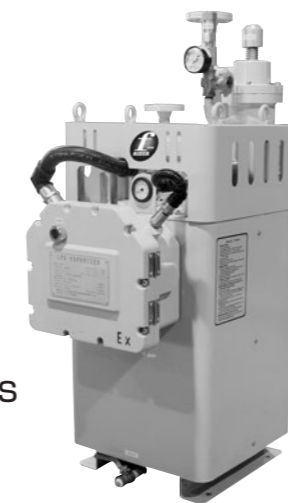

f RIZER ITOS

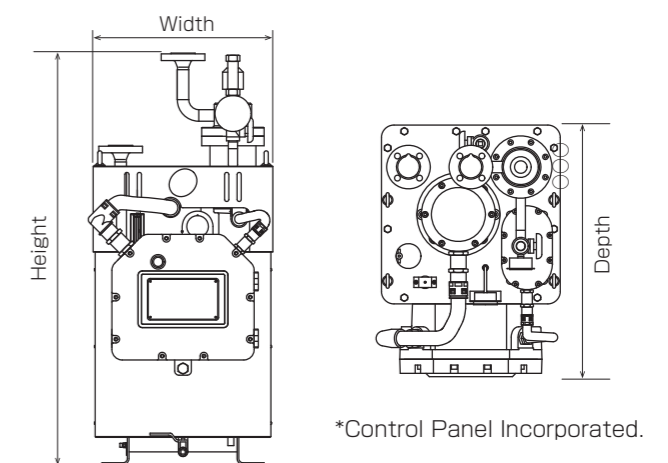

Specifications

Items	Model	ITOS-30	ITOS-50	ITOS-100	ITOS-150	ITOS-200	ITOS-300
Vaporisation Capacity (LPG)		30kg/h	50kg/h	100kg/h	150kg/h	200kg/h	300kg/h
Heat Source	Heater Capacity	4.5kW	7.5kW	15kW	22.5kW	30kW	45kW
	Rated Voltage	220V Single-Phase		220/380/440V 3-Phase			
Hot Water Control Temperature		60~80°C (75°C Set Point)					
Hot Water Superheat Prevention		85°C					
Liquid Carryover Protection		By means of Float Valve					
Working Pressure for Safety Valve		1.75MPa					
Inlet Pressure		0.10~1.60MPa					
Connection	Liquid Inlet Flange	DN20(PN25)			DN25(PN25)		
	Gas Outlet Flange	DN20(PN25)		DN25(PN25)			

Air Heating Type Vaporiser SR-SK Range for LPG Bulk Supply System



SR-50ASK

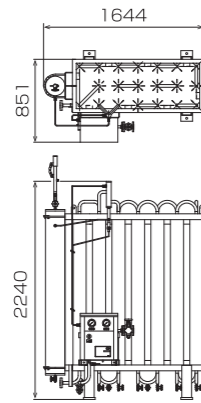

Model	SR-50ASK
Nominal Vaporising Ability Propane	50kg/h
Atmospheric Temperature	$\geq -5^{\circ}\text{C}$
Outlet Gas Temperature	$\geq -10^{\circ}\text{C}$
Nominal Continuous Operating Time*	4hours
Inlet Pressure	0.15~1.56MPa
Outlet Pressure	0.06~0.10MPa
Lockup Pressure	$\leq 0.96\text{MPa}$
Liquid Carryover Protection	Temperature Sensing Shut-Off (-20°C Set Point)
Working Pressure for Safety Valve	0.96MPa
Liquid Inlet	JIS 20K15A Flange
Gas Outlet	JIS 20K20A Flange

*Declared at being around 1m/sec. of wind speed.



SR-100BSK

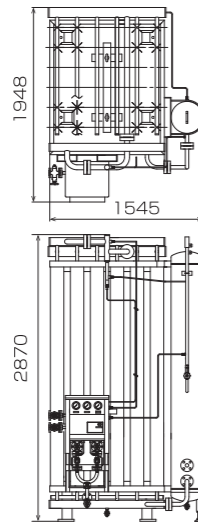

Model	SR-100BSK
Nominal Vaporising Ability Propane	100kg/h
Atmospheric Temperature	$\geq -5^{\circ}\text{C}$
Outlet Gas Temperature	$\geq -10^{\circ}\text{C}$
Nominal Continuous Operating Time*	10hours
Inlet Pressure	0.15~1.56MPa
Outlet Pressure	Service Side 0.09~0.11MPa Reserve Side 0.06~0.08MPa
Lockup Pressure	$\leq 0.96\text{MPa}$
Liquid Carryover Protection	Temperature Sensing Shut-Off (-20°C Set Point)
Working Pressure for Safety Valve	0.96MPa
Liquid Inlet	JIS 20K15A Flange
Gas Outlet	JIS 20K25A Flange

*Declared at being around 1m/sec. of wind speed.



SR-200ASK

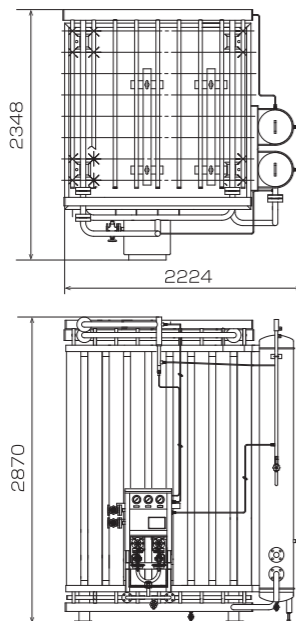

Model	SR-200ASK
Nominal Vaporising Ability Propane	200kg/h
Atmospheric Temperature	$\geq -5^{\circ}\text{C}$
Outlet Gas Temperature	$\geq -10^{\circ}\text{C}$
Nominal Continuous Operating Time*	10hours
Inlet Pressure	0.15~1.56MPa
Outlet Pressure	Service Side 0.09~0.11MPa Reserve Side 0.06~0.08MPa
Lockup Pressure	$\leq 0.96\text{MPa}$
Liquid Carryover Protection	Temperature Sensing Shut-Off (-20°C Set Point)
Working Pressure for Safety Valve	0.96MPa
Liquid Inlet	JIS 20K15A Flange
Gas Outlet	JIS 20K40A Flange

*Declared at being around 1m/sec. of wind speed.

Air Heating Type Vaporiser SR-W Range



*Long fin type, SR-WL is also available, which a minimal space requires.

External Dimensions

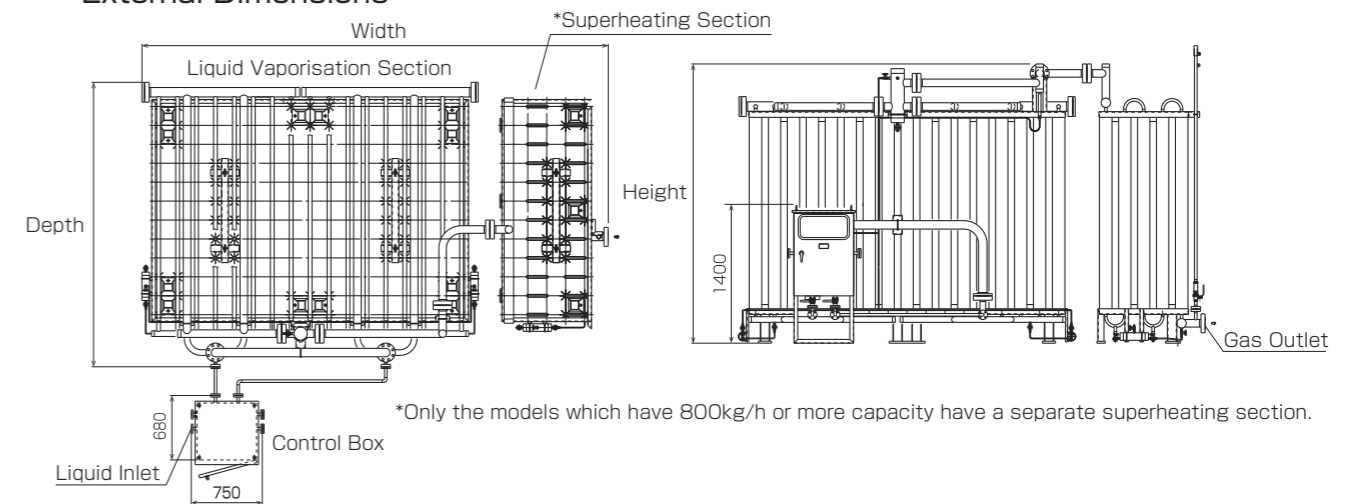

*Only the models which have 800kg/h or more capacity have a separate superheating section.

Specifications

Model	100W	150W	200W	300W	400W	500W	600W	700W	800W	1000W	1500W
Nominal Vaporising Ability Propane, kg/h	100	150	200	300	400	500	600	700	800	1000	1500
Atmospheric Temperature	$\geq -5^{\circ}\text{C}$										
Outlet Gas Temperature	$\geq -10^{\circ}\text{C}$										
Nominal Continuous Operating Time*	$\leq 5\text{hours}$										
Inlet pressure	0.15~1.56MPa										
Outlet Pressure	Service Side		0.10~0.12MPa								
	Reserve Side		0.07~0.09MPa								
Liquid Carryover Protection	Temperature Sensing Shut-Off (-20°C Set Point)										
Working Pressure for Safety Valve	1.56MPa										
Liquid Inlet	JIS20K20A Flange										
Gas Outlet	JIS20K Flange										
	25A	40A	50A	80A							
External Dimensions(mm)	Width	2032	2832	3032	2832	3632	4232	4432	4932	5812	5760
	Depth	1080	1140	1340	1740	2340	2540	2750	2950	2950	5394
	Height	2850						2900	2950	3131	

*Declared at being around 1m/sec. of wind speed. This vaporising ability is greatly affected by various factors. Please feel free to ask us for further information.

Bulk Tank Supply Systems

170T
298T 298Y
498T 498Y
980T 980Y
2900T 2900Y

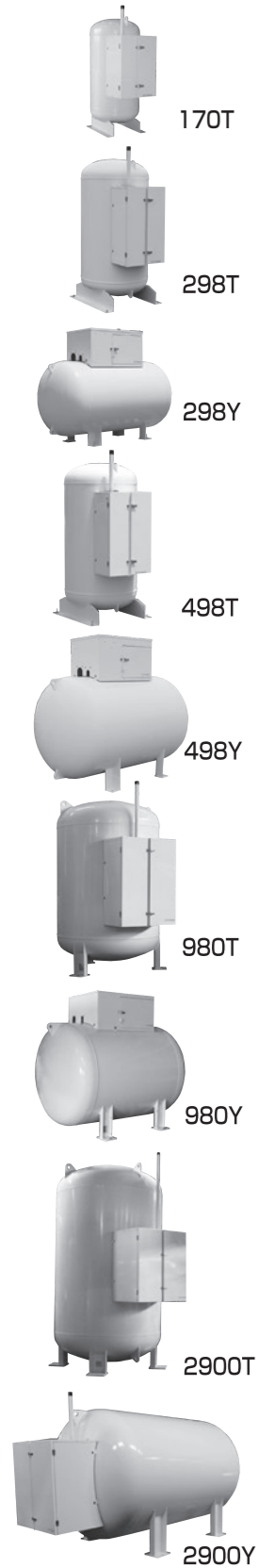
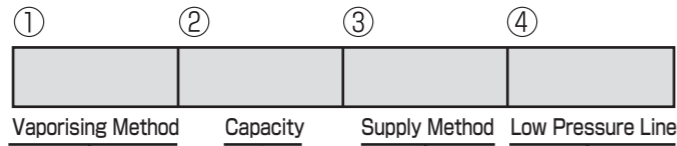

Code	Vaporising Method
0	Natural Vaporisation
3K	Dual Vaporisation
5K	
10K-BK	
R	
3M	Forced Vaporisation
5M	
10M-BK	
V	

Code	Capacity (Regulator or Vaporiser)
1	10kg/h
2	20kg/h
3	30kg/h
5	50kg/h
10	100kg/h

Code	Supply Method
1	Simplified Type
2	General Type
4	Multifunctional Type

Code	Low Pressure Line
	Single
W	Double

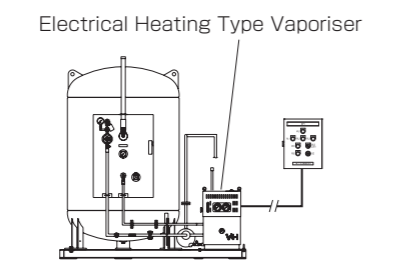
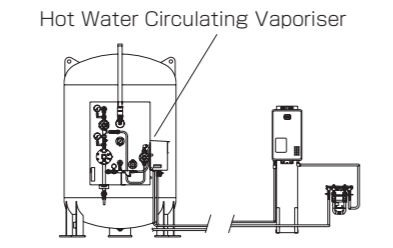
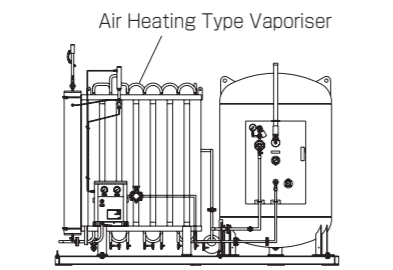
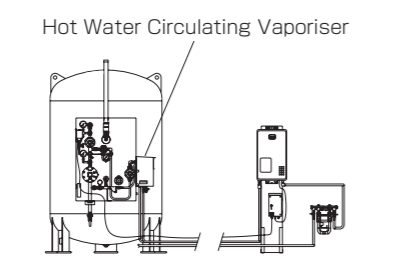
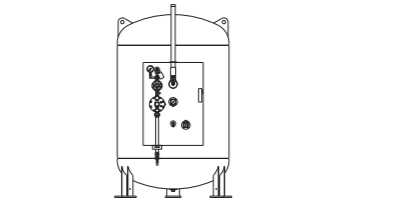

*The numbers show the vaporising ability. (3: 30kg/h, 5: 50kg/h, 10: 100kg/h)

*The numbers show the vaporising ability. (3: 30kg/h, 5: 50kg/h, 10: 100kg/h)

*Image for illustration purposes.

Double Stage Regulators for Bulk Tanks (with Excess Flow Valves)

Range Specification Inlet Pressure 0.07~1.56MPa Outlet Pressure 2.55~3.30kPa Lockup Pressure ≤ 3.50kPa

10kg/h

BRVS-10A (POL)

Inlet
POL
Outlet
Rc3/4Union

10kg/h

BRVS-10A (Rc 1/4)

Inlet
Rc 1/4
Outlet
Rc3/4Union

20kg/h

BRV-20A

Inlet
Rc 1/2
Outlet
Rc3/4Union

30kg/h

BRV-30A

Inlet
Rc 1/2
Outlet
Rc 1 Union

50kg/h

BRV-50A

Inlet
Rc3/4
Outlet
Rc 1 1/4Union

For Underground Tank

Model
BRV-20A
BRV-30A
BRV-50A

First Stage Regulators for Bulk Tanks (with Excess Flow Valves)

Range Specification

Model	BRV-30AM	BRV-50AM	BRV-70M	BRV-100M	BRV-200M
Inlet Pressure	0.10~1.56MPa		0.15~1.56MPa		
Outlet Pressure	0.057~0.083MPa				0.032~0.083MPa
Lockup Pressure	≤ 0.095MPa				

30kg/h

BRV-30AM

Inlet
Rc 1/2
Outlet
R1/2

50kg/h

BRV-50AM

Inlet
Rc3/4
Outlet
R3/4

70kg/h

BRV-70M

Inlet
Rc3/4
Outlet
Rc 1

100kg/h

BRV-100M

Inlet
Rc3/4
Outlet
Rc 1

200kg/h

BRV-200M

Inlet
Rc 1
Outlet
R1 1/2

For Underground Tank

Model
BRV-30AM
BRV-50AM
BRV-70M
BRV-100M

*Please inform our local branch or agency about accessories.